

# ASSEMBLY INSTRUCTIONS

## Self-Stabilizing Hand Truck

### Table of Contents:

Parts List .....	2
Assembly Instructions .....	3-6

*For safe, efficient product use, Magline recommends inspecting equipment regularly and replacing damaged components immediately.*

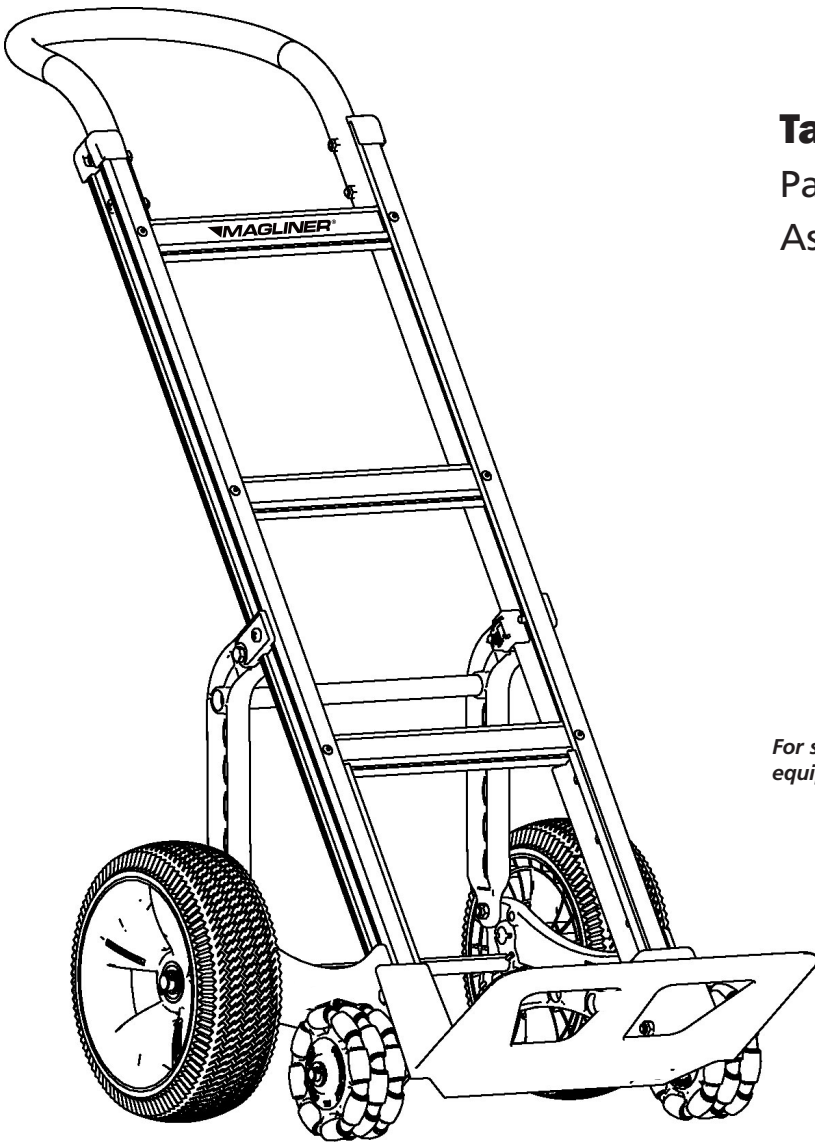

**MAGLINER®**

[www.magliner.com](http://www.magliner.com)

## TOOLS REQUIRED

- (2) 1/2" COMBINATION WRENCH OR SOCKET
- (1) #3 PHILLIPS SCREWDRIVER
- (1) HAMMER

- (1) PLIERS
- (1) 7/16" COMBINATION WRENCH OR SOCKET
- (1) 3/16" ALLEN WRENCH

## PARTS LIST

Item	Description	Qty.	Part No.
1	Handle	1	Varies
2	Frame	1	Varies
3	RH wheel bracket	1	210123
4	LH wheel bracket	1	210124
5	Nose plate	1	Varies
6	18" axle (16.81" for 815 wheels only)	1	22101 (or 22100)
7	Wheel	2	Varies
8	Side channel reinforcements	2	302001
9	Support arm	2	302900
10	Support clamp body	2	302901
11	Support clamp jaw	2	302902
12	Lift bar	1	302903
Kickstand/Multi-Directional Wheel Pack consists of items below:			
13	Kickstand axle	1	Varies
14	Roll pins for kickstand axle	2	81103
15	Kickstand lever assembly	1	302991
16	Kickstand cam	1	302995
17	Kickstand spring	1	302996
18	1/2" washer - thick	6	80782
19	Nylon washer - 1/2" x 1" x 1/16"	1	80171
20	1/2" washer - thin	6	80783
21	Cotter pin for wheel axle - 1/8" x 1" long	2	81077
22	Multi-directional wheel	2	130502 (double row) 130503 (triple row)
23	Rubber bumper ( <i>used only with flush mount extruded aluminum or steel noses</i> )	1	302998
24	Pan head machine screw - 1/4"-20 x 1-1/2" long	1	80105
25	Hex lock nut - 1/4"-20	1	80675
Hardware Pack 301034 consists of items below:			
26	Roll pin - 1/8" x 1-1/8"	2	190104
27	Hex head screw - 5/16"-18 x 1-1/2" long	2	80013
28	Hex head screw - 5/16"-18 x 1" long	2	80011
29	Hex head screw - 5/16"-18 x 2" long	4	80015
30	Hex lock nut - 5/16"-18	8	80676
31	5/8" washer - thin	2	80707
32	5/8" washer - thick	4	80705
33	Cotter pin for wheel axle - 1/8" x 1" long	2	81077
34	Pan head machine screw - 1/4"-20 x 1-1/2" long	4	80105
35	Pan head machine screw - 1/4"-20 x 3/4" long	2	80256
36	Hex lock nut - 1/4"-20	6	80675

Use a workbench or table of convenient height and place all components in view and within reach. It may be helpful to assemble the hand truck oriented face down. The following assembly sequence is recommended:

## ASSEMBLE THE NOSE, WHEEL BRACKETS AND MULTI-DIRECTIONAL WHEELS TO THE FRAME.

### Section 1a - Assemble reinforcements, nose and RH wheel bracket to frame.

#### Step 1

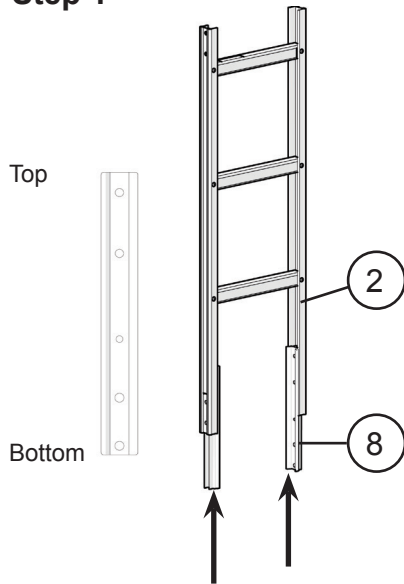

#### Step 2

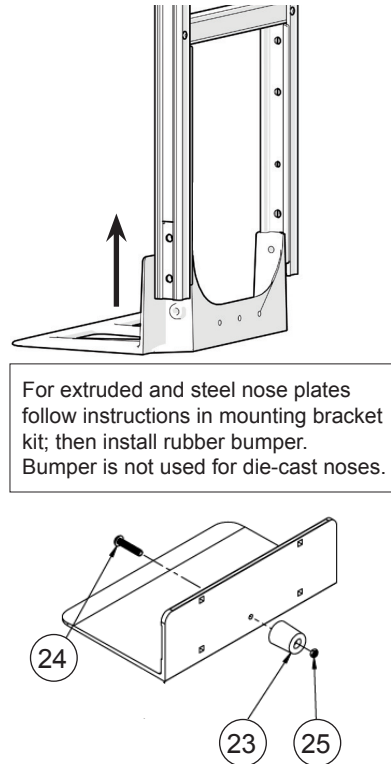

#### Step 3

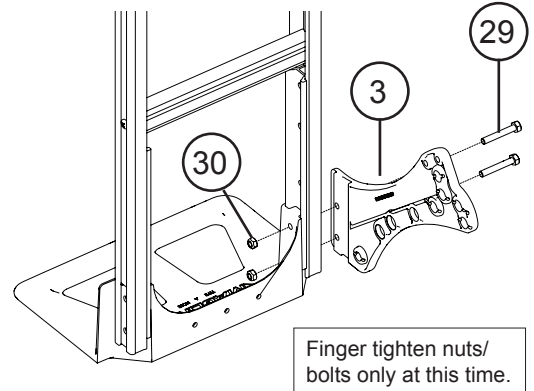

### Section 1b - Assemble kickstand roller; install kickstand assembly; install rear axle and multi-directional wheels.

#### Step 4

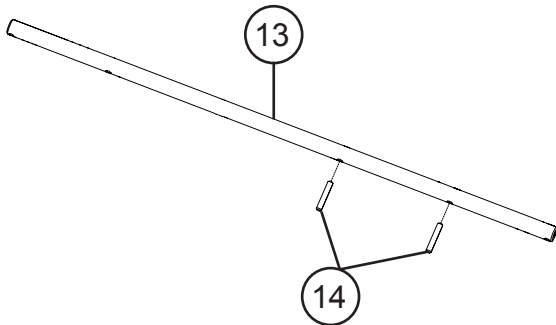

#### Step 5

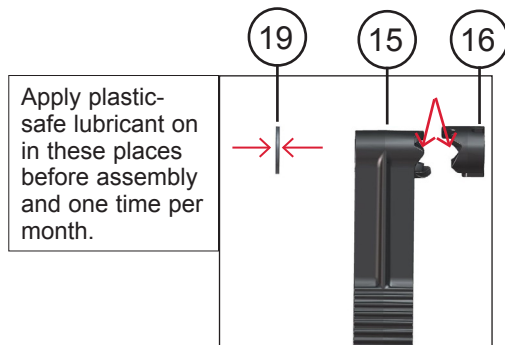

#### Step 6

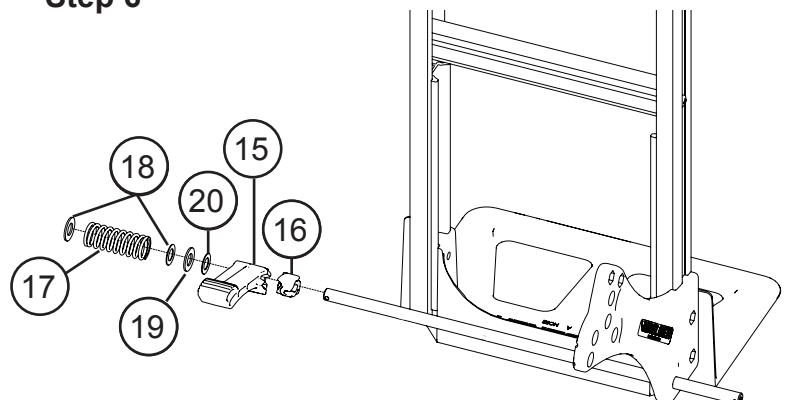

**Section 1c** - Select proper axle position based on the wheel diameter and the desired frame angle when hand truck is reclined.

**Step 7**

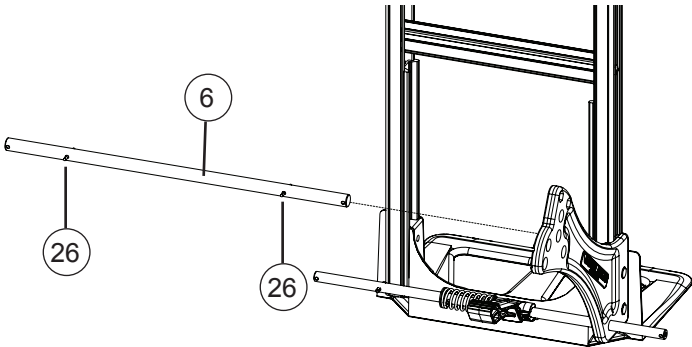

**Set-up the recline angle to suit the load**

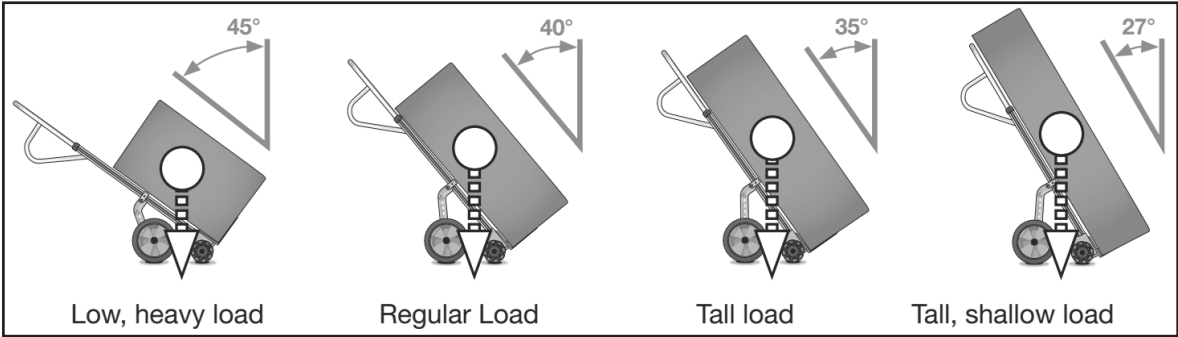

REAR AXLE POSITION	WHEEL DIA	RECLINE ANGLE (MEASURED OFF VERTICAL)
A	8"	45°
	10"	40°
B	8"	40°
	10"	35°
C	8"	38°
	10"	(see position E)
D	8"	32°
	10"	27°
E	8"	37°
	10"	32°

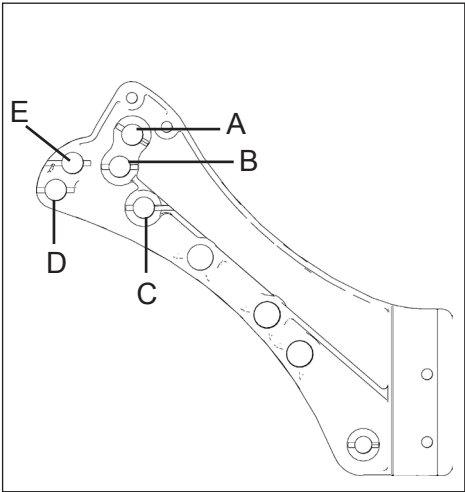

**Section 1d** - Assemble LH wheel bracket and multi-directional wheel.

**Step 8**

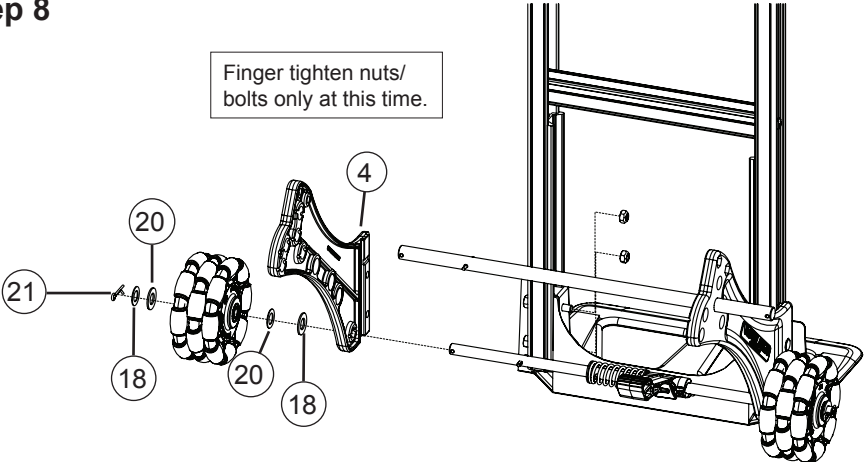

- IMPORTANT NOTES:**
- Be sure to orient the multi-directional wheel so that the text/logo faces AWAY from the frame.
  - Use the optimal number of extra washers in the kit to minimize side-to-side movement of the wheel on the axle which may vary slightly from diagram.

## ASSEMBLE THE SUPPORT ARMS TO THE FRAME.

### Section 2a -

1. Loosely install the support arms (9) at the bottom to the wheel brackets.
2. Loosely install the support clamp body (10) and support clamp jaw (11) with hardware.
3. Place the lift bar (12) between the support arms.

### Step 9

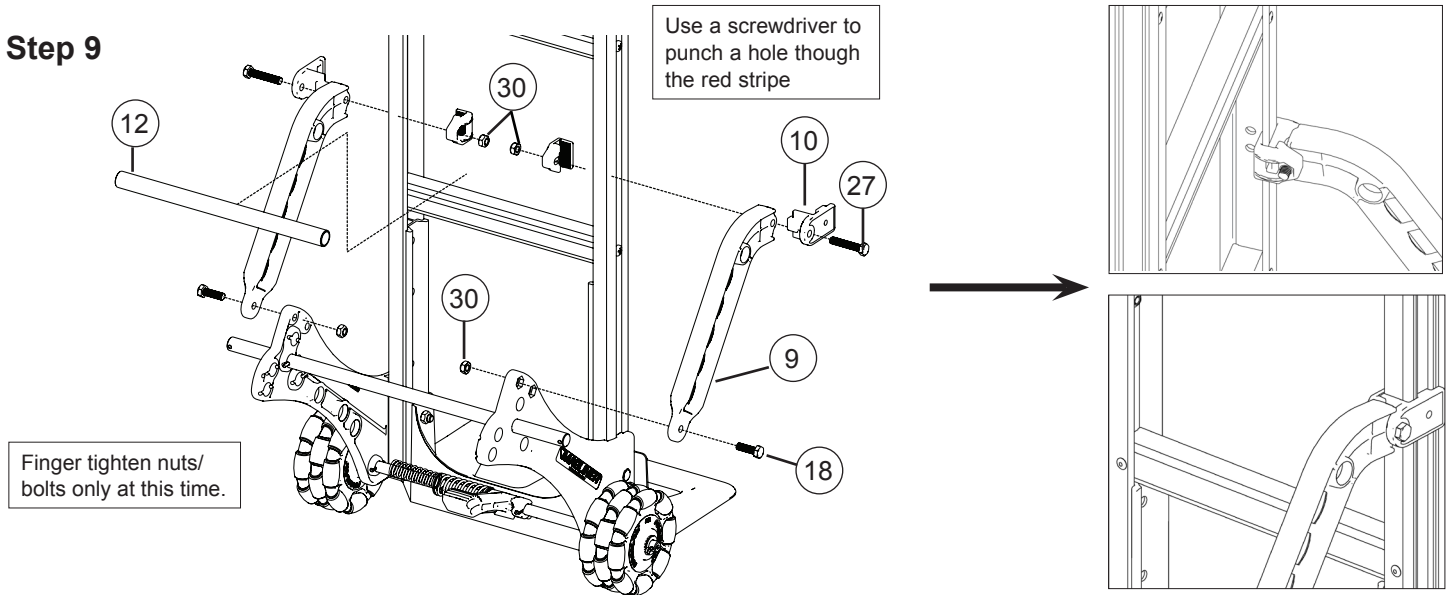

### Section 2b - Secure support clamp body to the frame.

### Step 10

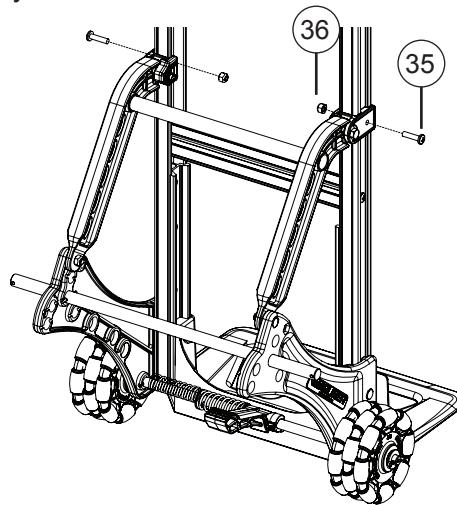

## ASSEMBLE THE WHEELS

### Step 11

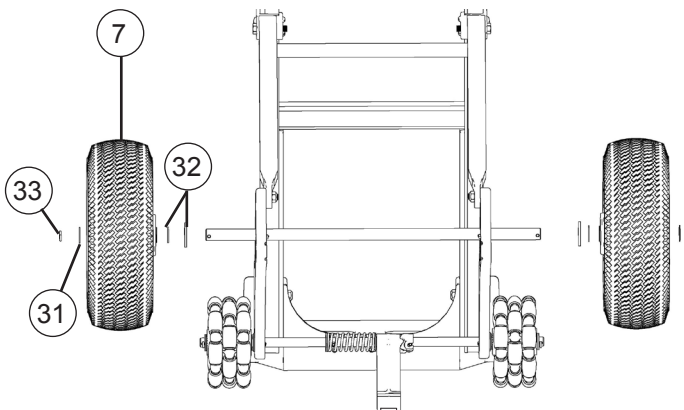

#### IMPORTANT NOTES:

- (FOR 815 WHEELS ONLY) Slide one thick 5/8" washer (24) on the axle. (FOR ALL OTHER WHEELS) Slide two thick 5/8" washers on the axle.
- Make sure that the long hub portion is toward or next to the wheel bracket

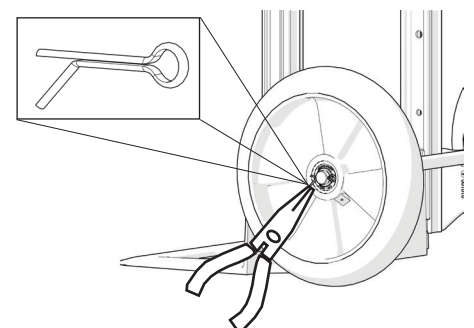

## ASSEMBLING THE HANDLE AND FINAL TIGHTENING

Check all components assembled so far for proper location. Make any adjustments required. Securely tighten all bolts at this time, including the nose and wheel bracket bolts. (Tighten nose bracket bolts to 100-120 in.-lbs. and support arm bolts to 1/4"-20 to 50-60 in.-lbs. torque.)

Place black frame caps on frame. Position the handle and fasten with handle hardware. Securely tighten (1/4"-20 screws to 50-60 in.-lbs. torque).

### Step 12

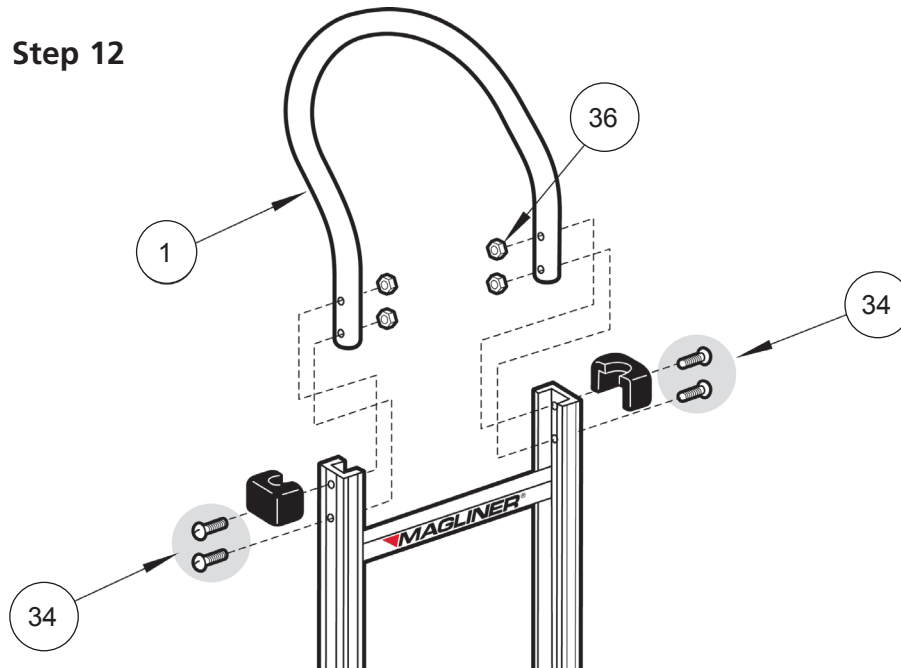

## INSERTING LOADING INSTRUCTION STRIPE

1. Place the stripe on the front of the bottom cross brace if your frame has no vertical strap at the front of the frame; otherwise the stripe will be placed on the back of the bottom cross brace.
2. Make sure the cross brace is clean and free of debris. If needed, clean the cross brace with a mild solvent. Let completely dry.
3. For cross braces with grooves - Gently pinch the ends of the long plastic stripe so that the stripe begins to gently bend in half lengthwise. While pinched, place the top end of a stripe against the cross brace and carefully slide the stripe up underneath the top groove and the bottom end of the stripe against the cross brace. Gently release the pinched stripe so that the bottom edge slides into the bottom groove. It may be helpful to use a thin, flat object such as a credit card to help guide the stripe into place.
4. For cross braces without grooves - Apply adhesive label to the cross brace.

### Step 13

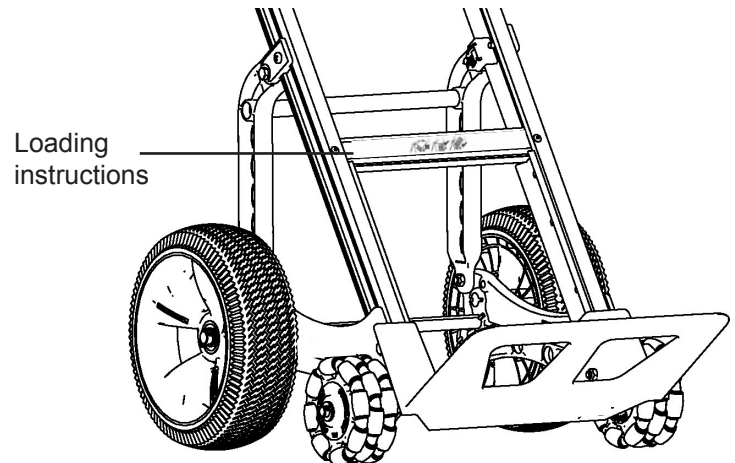
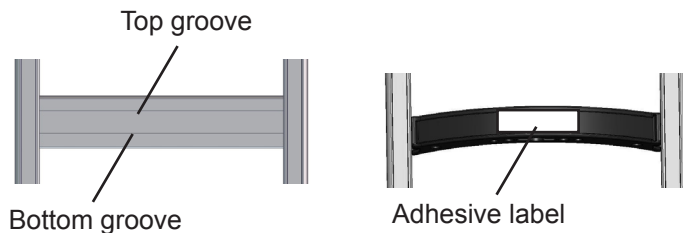

[www.magliner.com](http://www.magliner.com)

Magline, Inc., 1205 West Cedar Street, Standish, MI 48658 • (800) 624-5463 • (989) 512-1000