

ASSEMBLY INSTRUCTIONS

Self-Stabilizing Hand Truck with C5 Stair Climbers

Table of Contents:

Parts List	2
Assembly Instructions	3-6

For safe, efficient product use, Magline recommends inspecting equipment regularly and replacing damaged components immediately.

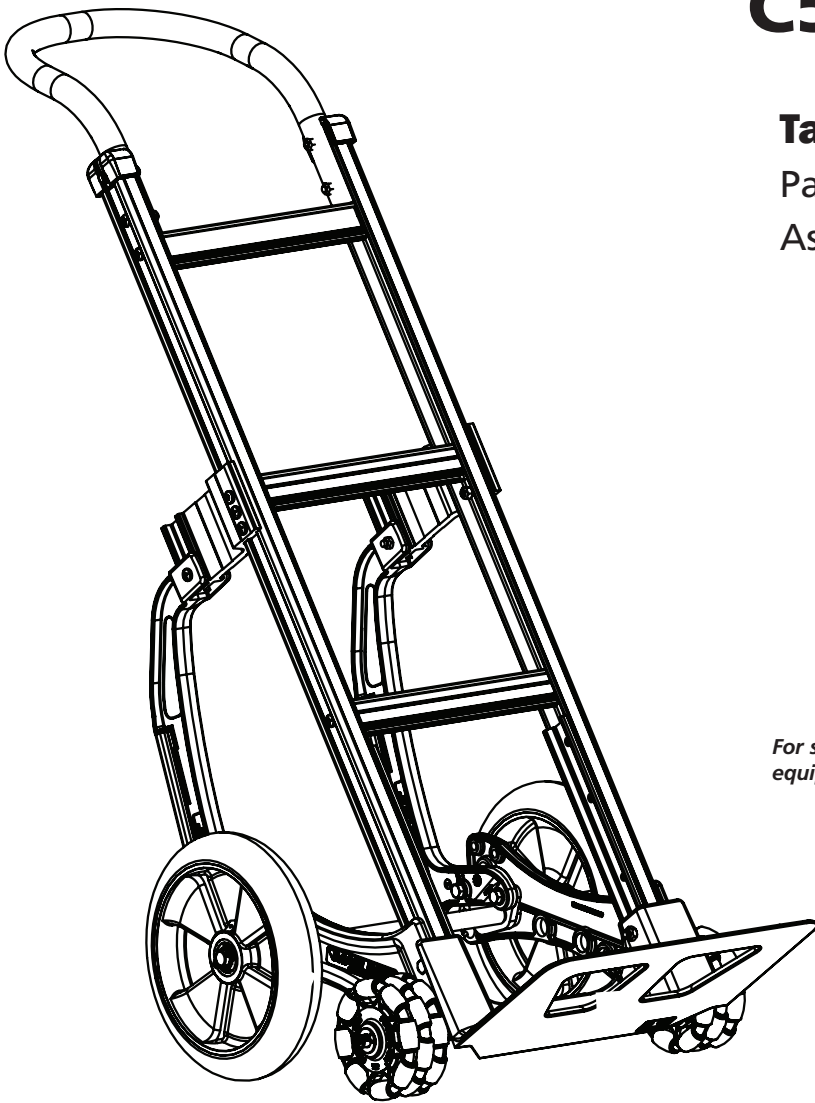

MAGLINER®

www.magliner.com

TOOLS REQUIRED

- (2) 1/2" COMBINATION WRENCH OR SOCKET
- (1) #3 PHILLIPS SCREWDRIVER
- (1) HAMMER
- (1) PLIERS
- (1) 7/16" COMBINATION WRENCH OR SOCKET
- (1) T30 TORX DRIVER
- (1) 3/16" ALLEN WRENCH

ADDITIONAL TOOLS REQUIRED TO RETROFIT TO EXISTING TRUCK:

- (1) ELECTRIC DRILL
- (1) 5/16" DRILL BIT

Item	Description	Qty.	Part No.
1	Handle	1	Varies
2	Frame	1	Varies
3	LH wheel bracket	1	210124
4	RH wheel bracket	1	210123
5	Nose plate	1	Varies
6	18" axle (16.81" for 815 wheels only)	1	22101 (or 22100)
7	Wheel (C5 option compatible with 10" wheels only)	2	Varies
8	Side channel reinforcements	2	302001
9	C5 stair climber	2	302098
10	Stair climber glide bracket	2	302972
11	Spreader tube	1	302971
12	C5 adapter bracket - RH	1	302969
13	C5 adapter bracket - LH	1	302970
Kickstand/Multi-Directional Wheel Pack consists of items below:			
14	Kickstand axle	1	Varies
15	Roll pins for kickstand axle	2	81103
16	Kickstand lever	1	302991
17	Kickstand cam	1	302995
18	Kickstand spring	1	302996
19	1/2" washer - thick	6	80782
20	Nylon washer - 1/2" x 1" x 1/16"	1	80171
21	1/2" washer - thin	6	80783
22	Cotter pin for wheel axle - 1/8" x 1" long	2	81077
23	Multi-directional wheel	2	130502 (double row) 130503 (triple row)
24	Rubber bumper (<i>used only with flush mount extruded aluminum or steel noses</i>)	1	302998
25	Pan head machine screw - 1/4"-20 x 1-1/2" long	1	80105
26	Hex lock nut - 1/4"-20	1	80675
Hardware kit 301033 contains the following parts:			
27	Cotter pin for wheel axle - 1/8" x 1" long	2	81077
28	Roll pin - 1/8" x 1-1/8"	2	190104
29	Hex head screw - 5/16"-18 x 2" long	4	80015
30	Hex lock nut - 5/16"-18	4	80676
31	Hex head thread forming screw - 5/16"-18 x 1" long	4	80344
32	5/8" washer - thin	6	80707
33	5/8" washer - thick	4	80705
34	Pan head machine screw - 1/4"-20 x 1-7/8" long	2	80039
35	Pan head thread forming screw - 1/4"-20 x 1-1/4" long	2	80340
36	Pan head machine screw - 1/4"-20 x 1" long	4	80102
37	Pan head machine screw - 1/4"-20 x 1-1/4" long	2	80104
38	Pan head machine screw - 1/4"-20 x 1-1/2" long	4	80105
39	Hex lock nut - 1/4"-20	10	80675

Use a workbench or table of convenient height and place all components in view and within reach.

Step 1

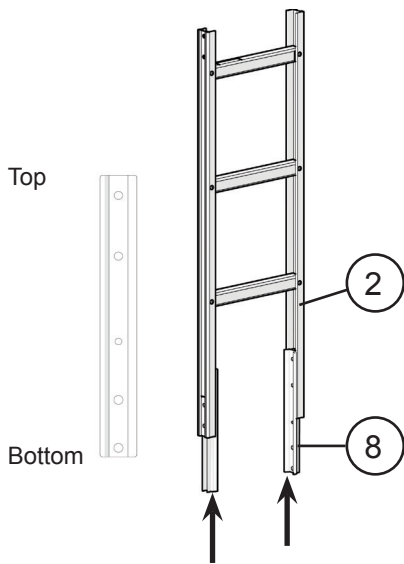

Step 2

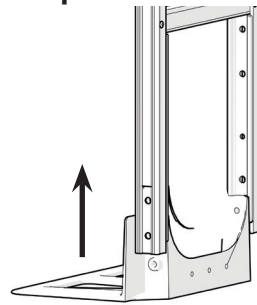

For extruded and steel nose plates follow instructions in mounting bracket kit; then install rubber bumper. Bumper is not used for die-cast noses.

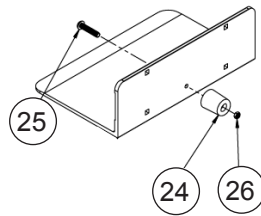

Step 3

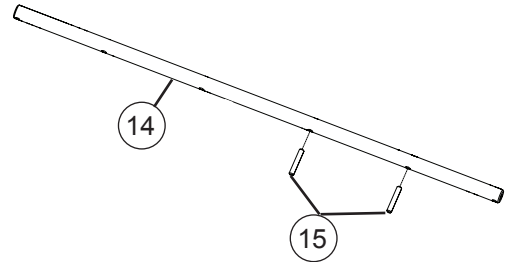

Step 4a

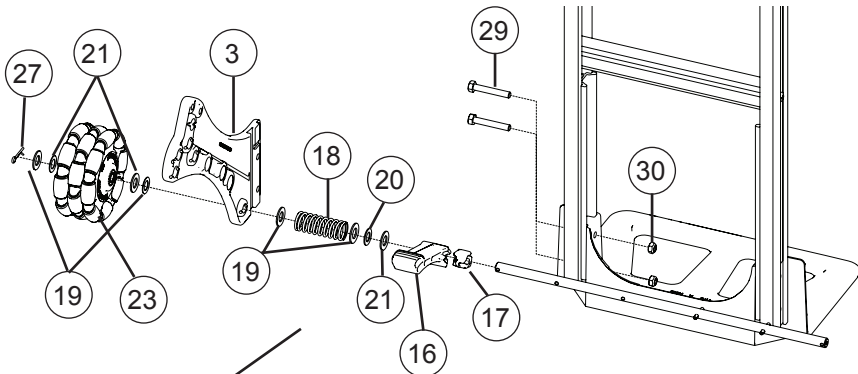

Step 5

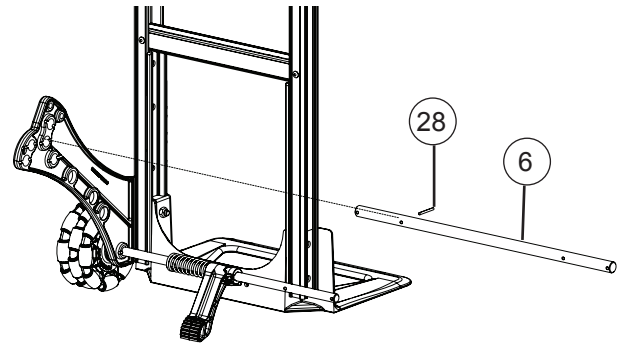

Step 4 Note:

Apply plastic-safe lubricant on in these places before assembly and one time per month.

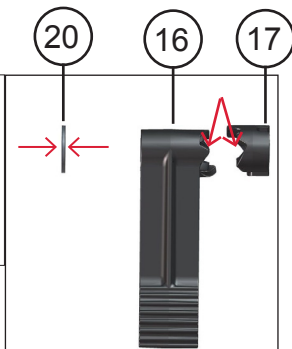

Set-up the recline angle to suit the load

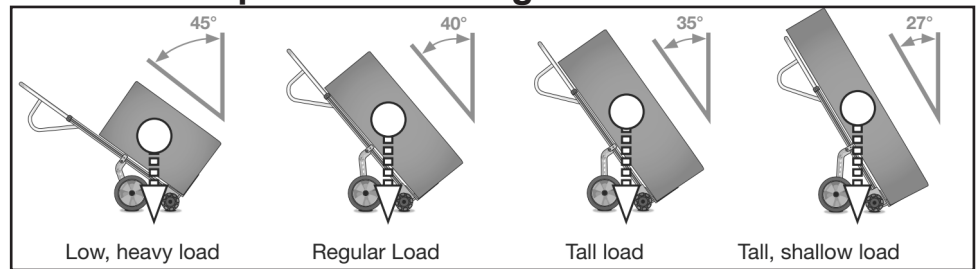

REAR AXLE POSITION	WHEEL DIA	RECLINE ANGLE (MEASURED OFF VERTICAL)
A	10"	40°
B	10"	35°
C	10"	32°
D	Do not use	
E	Do not use	

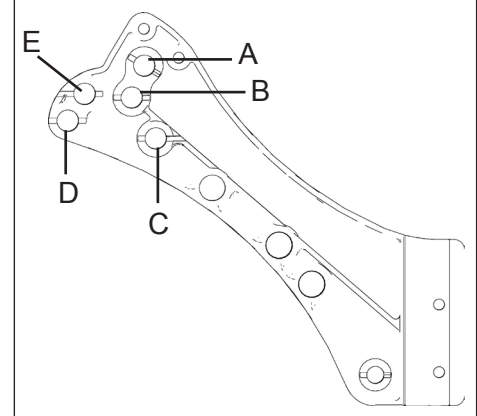

Note: Stair climbing option compatible with 10" wheels only.

Step 6

Install two washers and one stair glide onto the axle as shown. Next slide the spreader tube onto the axle.

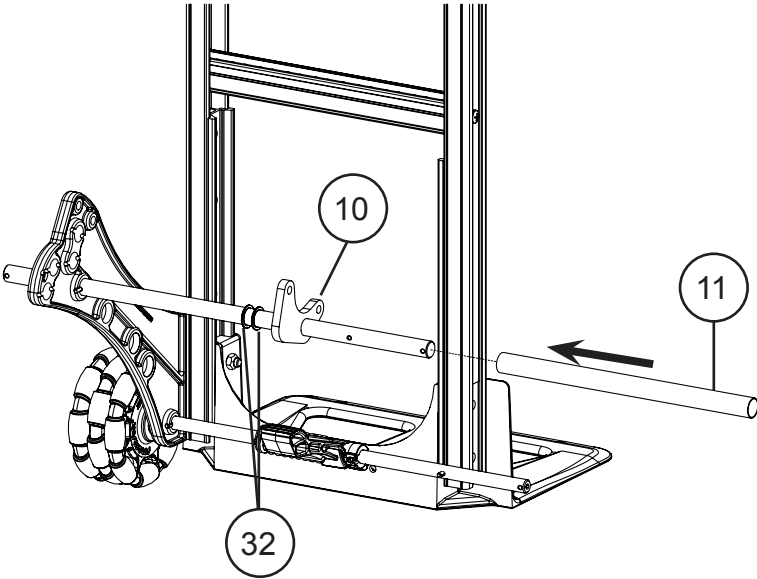

Step 7

Install the second stair glide and two washers onto the axle as shown.

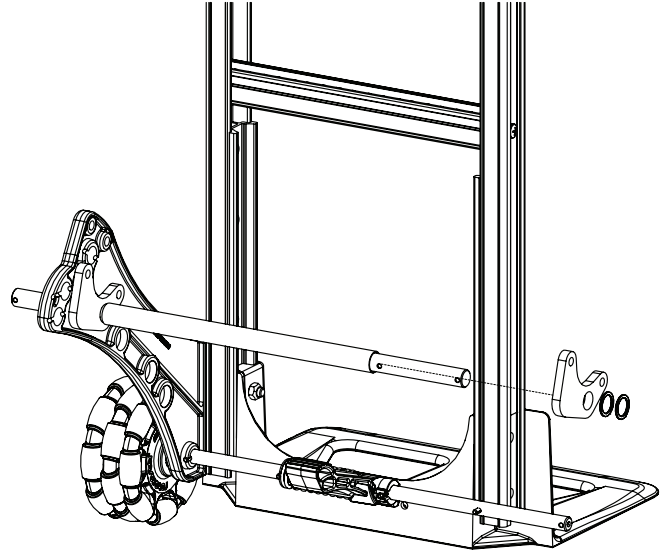

Step 8

Install the second roll pin onto the axle - you may need to remove the last washer if it covers up the hole in the axle. Install the RH wheel bracket, washers, multi-directional caster and cotter pin (see Steps 1a and 1c for reference).

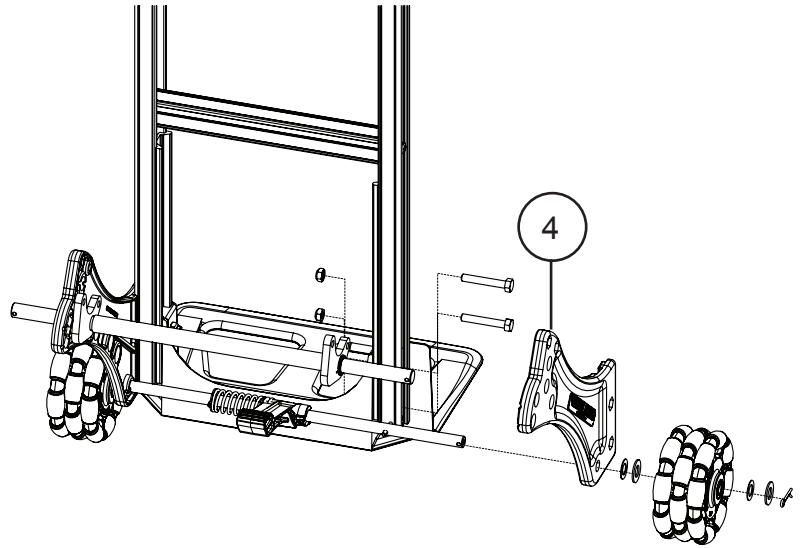
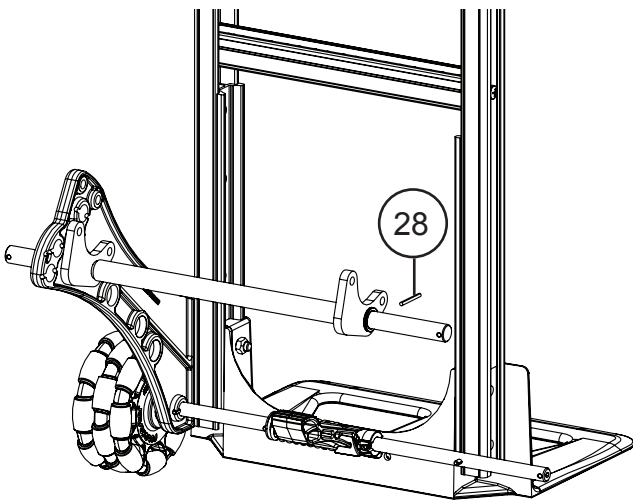

Step 9

Install the stair climbers to the glide brackets using the hex head thread-forming screws. Tighten these 5/16"-18 thread forming screws to 140 - 150 in-lbs. of torque.

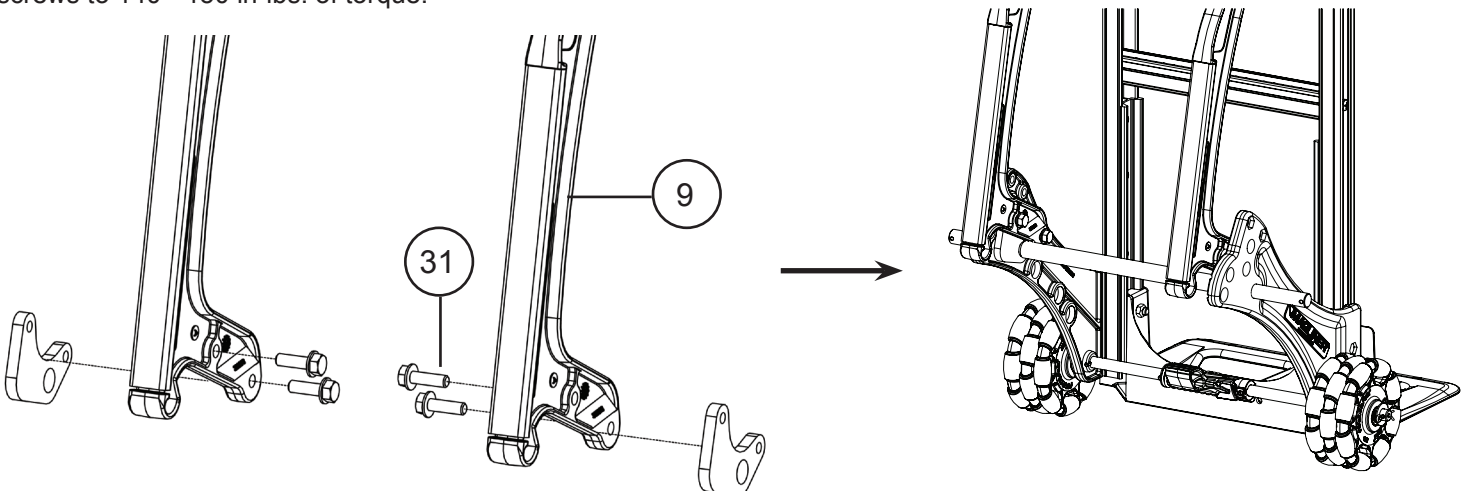

Step 10

Install each stair climber/bracket assembly to an adapter bracket. Finger tighten only for now. The axle location in the wheel bracket determines which hole in the bracket is used - see diagram below.

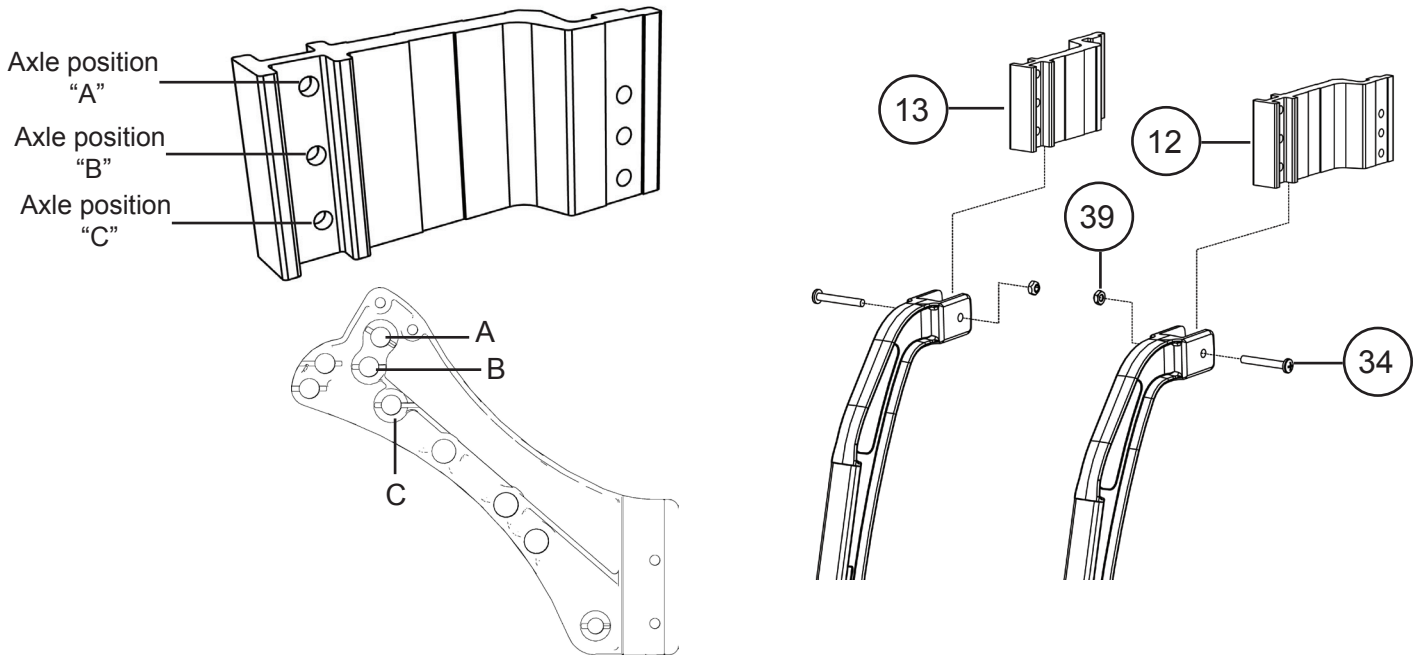

Step 11

Attach the stair climber assembly to the hand truck frame using the images below as a guide for securing the bracket to the hand truck.

39" Frames

For bolted frames: Remove the bolt securing the middle brace to the frame from one side of the frame (for molded cross braces, make sure the lock nut in the cross brace stays in place). Rotate the C5 and bracket assembly toward the frame and align the key of bracket with the outside of the frame. Replace the removed screw with the 1/4"-20 thread forming screw for aluminum frames and the 1/4"-20 x 1-1/4" long pan head screw for molded cross brace frames. If a hole does not exist in the frame in the bottom hole location of bracket, drill a hole using a 5/16" drill using the bracket as a guide. Secure with 1/4"-20 x 1" long pan head screw and hex lock nut. Repeat for the other side.

For riveted frames (manufactured before June 2015): Rotate the C5 and bracket assembly toward the frame and align the key of bracket with the outside of the frame. If a hole does not exist in the frame in the bottom hole location of bracket, drill a hole using a 5/16" drill using the bracket as a guide. Secure with 1/4"-20 x 1" long pan head screw and hex lock nut. This is the only place to secure the bracket on a riveted 39" frame.

Aluminum Cross Braces:

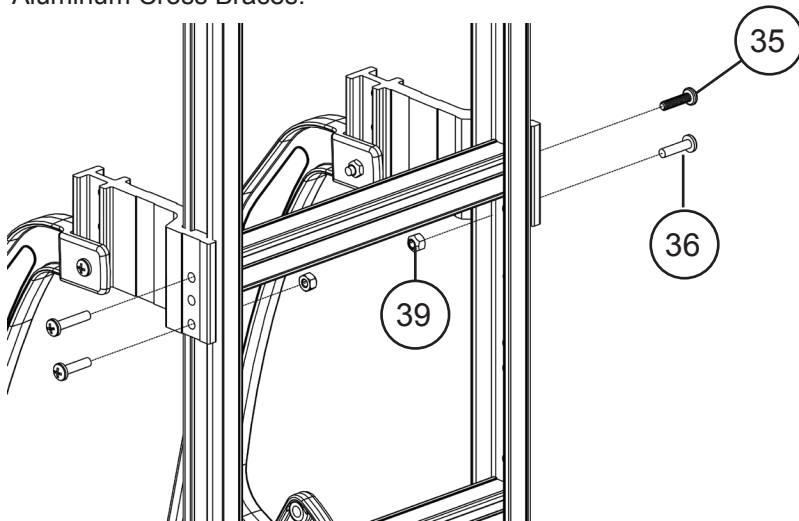

Molded Cross Braces:

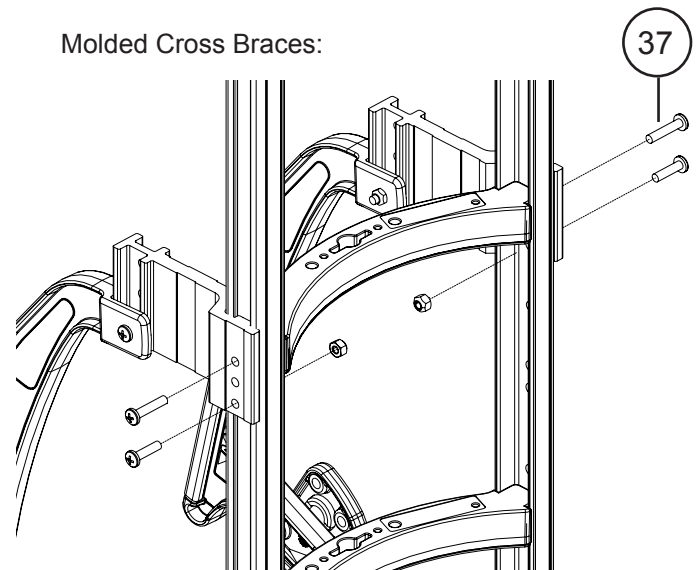

52" Frames

For all frames: Rotate the C5 and bracket assembly toward the frame and align the key of bracket with the outside of the frame. If a hole does not exist in the frame in the bottom hole location of bracket, drill a hole using a 5/16" drill using the bracket as a guide. Secure with 1/4"-20 x 1" long pan head screw and hex lock nut. Repeat for the other side.

Aluminum Cross Braces:

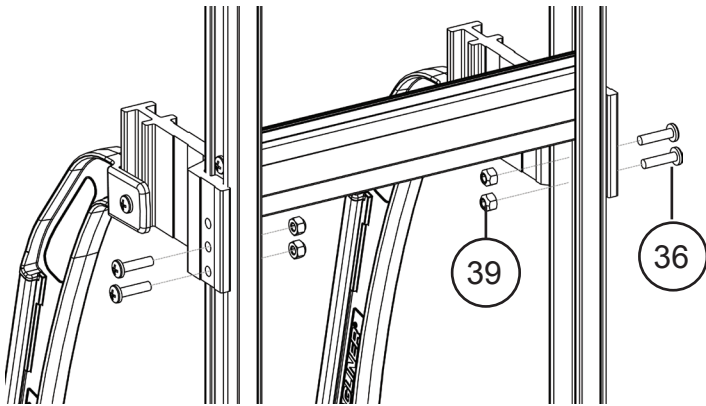

Molded Cross Braces:

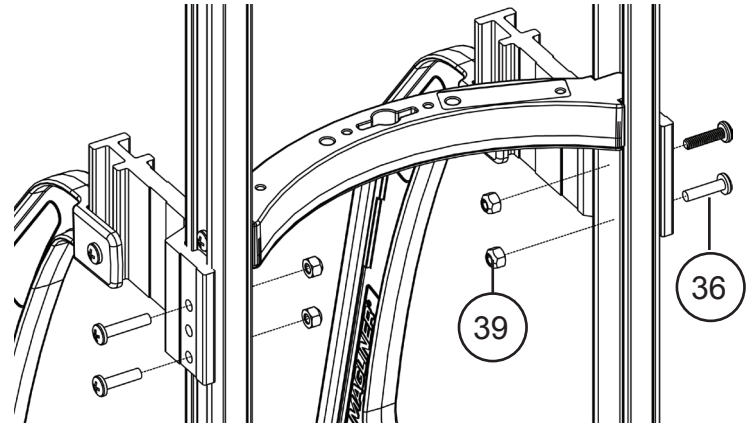

Step 12

Assemble the wheels onto the hand truck as shown. For 815 wheels, use only one thick washer between the wheel bracket and wheel - for all others, use two.

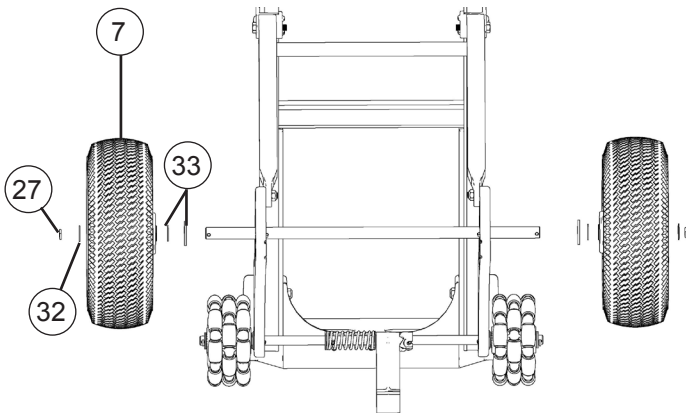

Step 13

Assemble the handle onto the hand truck frame as shown. Tighten bolts to 50-60 in.-lbs. of torque.

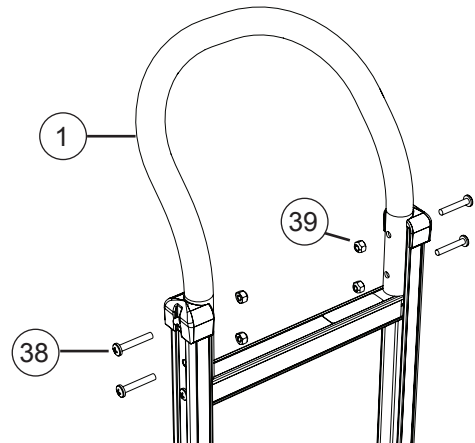

Make any final adjustments and tighten all 1/4"-20 bolts in to 50-60 in.-lbs. of torque. At this time tighten all nose bracket bolts to 100-120 in.-lbs. of torque.

Final Step

Insert the loading instruction stripe onto the bottom cross brace. Place it in the front of the frame if you have aluminum cross braces and no vertical strap; otherwise the stripe will be placed on the back of the bottom cross brace. Gently pinch the ends of the stripe so that it begins to gently bend in half lengthwise. Carefully slide the stripe up underneath the top groove and then gently release the pinched stripe so that the bottom edge slides into the bottom groove. For cross braces without grooves - apply adhesive label to the cross brace.

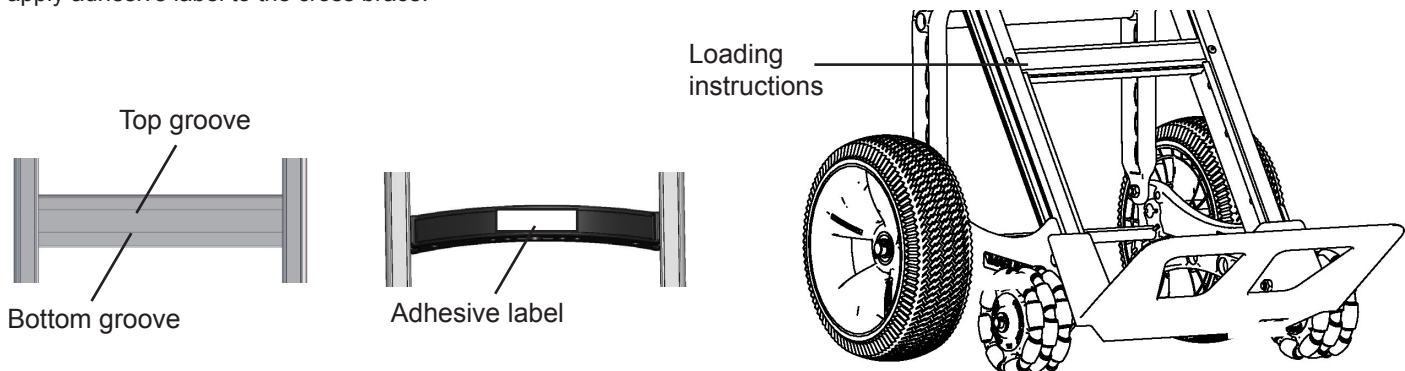

www.magliner.com

Magline, Inc., 1205 West Cedar Street, Standish, MI 48658 • (800) 624-5463 • (989) 512-1000