

# COMMERCIAL HANDLE (PART NO. 306167)

Item	Description	Qty.	Part No.
A	Side rail	2	306146
B	Cross brace	3	306168
C	Hex washer head thread forming screw - 1/4"-20 x 1-1/2" long	6	80332
D	End cap	2	306145

## REQUIRED TOOLS

- (1) 1/4" DRIVE SOCKET WRENCH
- (1) 3/8" SOCKET
- ISOPROPYL ALCOHOL

### Side Rail and Cross Brace Orientation

Note: To locate the top of the side rail, find the end of the rail with the shorter distance between the cross brace mounting holes and the end of the side rail. When orienting the cross braces, the open end of the brace is always on the bottom (see Figure 1).

### Assembly Instructions

1. Position both side rails (A) and arrange all three cross braces (B) on a flat work bench paying attention to the top and bottom of the side rail (A) as described above.
2. Align the lowest cross brace with the bottom hole of one side rail, ensuring the open end is toward the bottom of the assembly. Fasten one side with the thread forming screw (C).
3. With the middle cross brace in position and in the same orientation as the lowest cross brace, fasten it to the side rail (A) as described in Step 2.
4. If applicable, insert personalization stripes into the groove on both sides of the middle cross brace (C).
5. With the bottom two cross braces in place, fasten the other side rail to these cross braces using the thread forming screw (C).
6. Install both red stripes.
7. If applicable install Magliner label into the grooves on each side of the top cross brace (B).
8. Insert both end caps (D) onto each side of the top cross brace (B) as shown in Figure 2.
9. Firmly press the top cross brace (B) with the end caps (D) onto the top of the exposed side rails.
10. Fasten to the cross brace with the remaining thread forming screws (C). Note: Access the top mounting screws through the hole in the side of the end cap.

**NOTE:** Tighten all screws to 100-120 in-lbs.

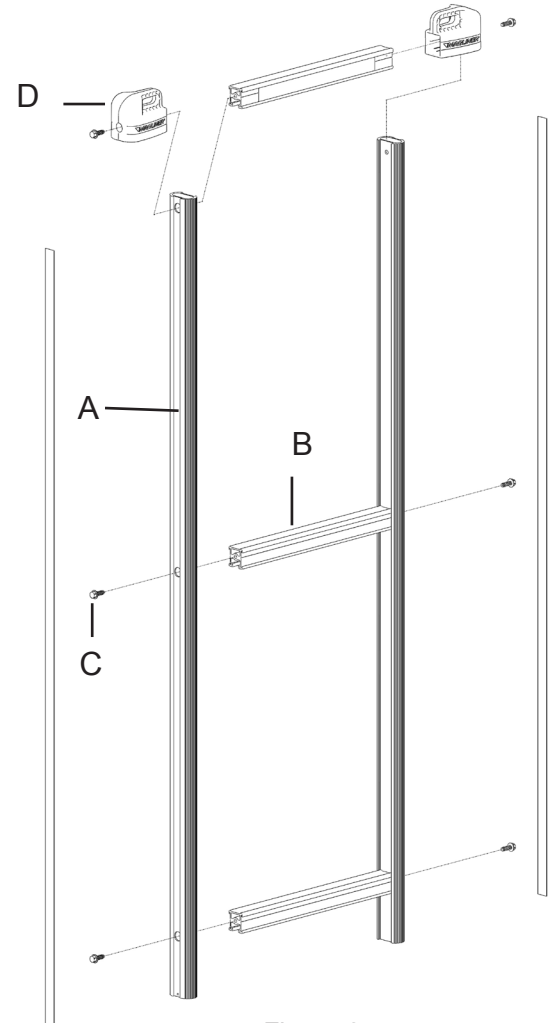
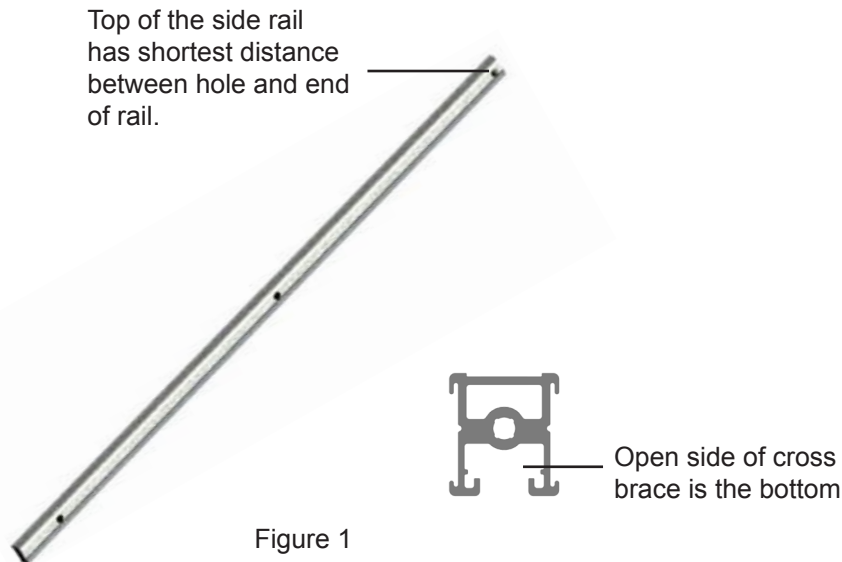

# INDUSTRIAL HANDLE (PART NO. 306150)

Item	Description	Qty.	Part No.
A	Side rail	2	306146
B	Cross brace	1	306143
C	Hex washer head thread forming screw - 1/4"-20 x 1-1/2" long	6	80332
D	Pan head thread forming screw - 1/4"-20 x 3/4" long	3	80308
E	Vertical strap	1	306142
F	End cap	2	306145

## REQUIRED TOOLS

- (1) 1/4" DRIVE SOCKET WRENCH
- (1) 3/8" SOCKET
- ISOPROPYL ALCOHOL

### Side Rail and Cross Brace Orientation

Note: To locate the top of the side rail, find the end of the rail with the shorter distance between the cross brace mounting holes and the end of the side rail. When orienting the cross braces, the open end of the brace is always on the bottom (see Figure 1).

### Assembly Instructions

1. Position both side rails (A) and arrange all three cross braces on a flat work bench paying attention to the top and bottom of the side rail (A) as described above.
2. Align one cross brace (B) with the bottom hole of one side rail, ensuring the open end is toward the bottom of the assembly. Fasten one side with a hex head thread forming screw (C).
3. With a second cross brace (B) in position in the middle of the side rail and in the same orientation as the lowest cross brace, fasten it to the side rail (A) as described in Step 2.
4. If applicable, insert personalization stripes into the groove on both sides of the middle cross brace.
5. With the bottom two cross braces in place, fasten the other side rail to the cross braces using the thread forming screw (E).
6. Install both red stripes.
7. If applicable install Magliner label into the grooves on each side of the upper cross brace (B).
8. Insert both end caps (H) onto each side of the last cross brace (B) as shown in Figure 2.
9. Firmly press the upper cross brace (B) with the end caps (H) onto the top of the exposed side rails.
10. Fasten the top cross brace with the remaining thread forming screws (E). Note: Access the top mounting screws through the hole in the side of the end cap.
11. (Install vertical straps)

**NOTE:** Tighten all screws to 100-120 in-lbs.

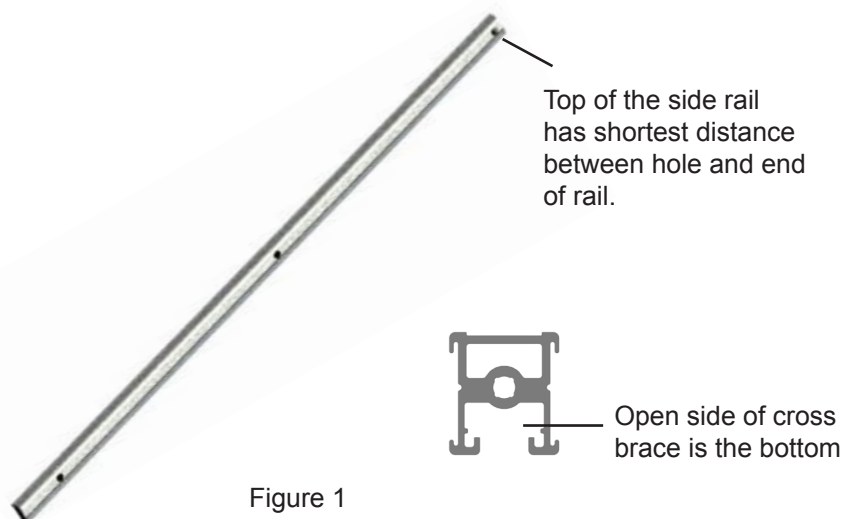

Figure 1

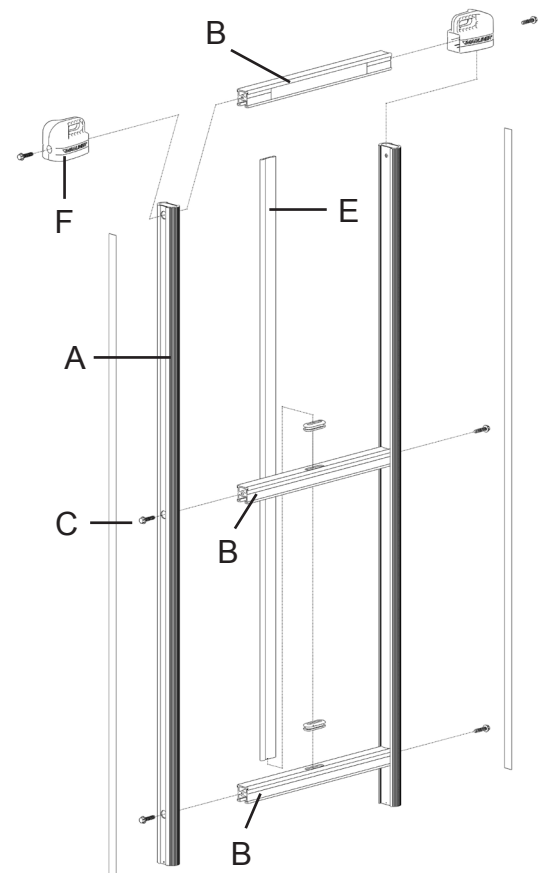

Figure 2